

# QUALCAST

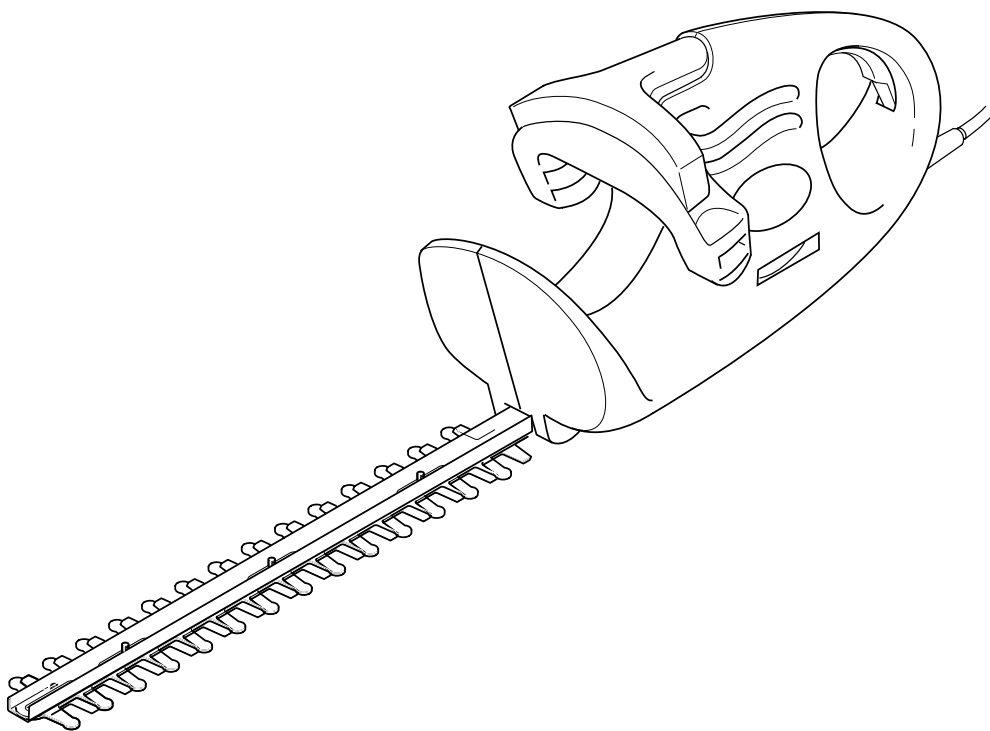

**HEDGEMASTER  
OPERATING INSTRUCTIONS**

# Safety Rules



**WARNING ! Read these instructions carefully**  
**Be familiar with the controls and the proper use of the hedgecutter.**  
**This machine can cause serious injuries if not used as intended.**

## Explanation of Symbols on the hedgecutter



1) Read instruction manual.



2) Switch off and remove plug from mains before cleaning, if the cable is entangled or if the cable is cut or damaged.



3) Do not use the hedgecutter in the rain or leave it outdoors when it is raining.

Other persons and animals should remain at a distance of 3 metres or more when the machine is being used.

Never grasp the blade of the hedgecutter.

Never allow children or people unfamiliar with these instructions to use the hedgecutter. Local regulations may restrict the age of the operator.

Never cut a hedge while people, especially children or pets are nearby.

The operator or user is responsible for accidents or hazards occurring to other people or their property.

Take care when using your appliance. Do not operate it when you are tired.

Do not operate the hedgecutter when barefoot or wearing open sandals, always wear substantial footwear and long trousers. The use of sturdy gloves, non-skid footwear and safety glasses is recommended. Do not wear loose clothing or jewellery which can be caught in moving parts.

Thoroughly inspect the area where the hedgecutter is to be used and remove all wires and other foreign objects.

Before using, always visually inspect to see that the cutter blades, blade bolts and cutter assembly are not worn or damaged. Do not operate with a damaged or excessively worn cutting device.

Avoid unintentional starting. Do not carry a plugged in appliance with your finger on the switch.

Check cable for damage before starting work and replace if necessary - never carry the appliance by the cable or yank it to disconnect it from the socket.

Keep the cable away from heat, oil and sharp edges.

Know how to stop the hedgecutter quickly in an emergency.

Cut a hedge only in daylight or in good artificial light.

Never operate the hedgecutter with defective guards or without the guard in place

Always ensure all handles and guards supplied are fitted when using the hedgecutter. Never attempt to use an incomplete hedgecutter or one with an unauthorised modification.

Always use two hands to operate the hedgecutter.

Never hold the hedgecutter by the guard.

Keep cable away from the cutting area.

While operating the hedgecutter always be sure of a safe and secure operating position especially when using steps or a ladder.

Always be aware of your surroundings and stay alert for possible hazards that you may not hear whilst operating the hedgecutter.

## Remove the plug from the socket:-

- before checking, clearing a blockage or working on the hedgecutter;
- after striking a foreign object. Inspect the hedgecutter for damage and make repairs as necessary;
- if the hedgecutter starts to vibrate abnormally (check immediately).

Keep all nuts, bolts and screws tight to be sure that the hedgecutter is always in a safe working condition.

After use the appliance should be stored so that the blade is not exposed - and when not in use the appliance should be stored in a dry, high or locked up place, out of reach of children.

Replace worn or damaged parts for safety.

Do not attempt to repair the appliance unless you are qualified to do so.

The appliance has been manufactured to specific safety requirements. Repairs should only be carried out by qualified persons using original spare parts, otherwise this may result in considerable danger to the user.

Ensure that only Qualcast Approved replacement parts are fitted.

## Introduction

Thank you for buying your new Qualcast hedgecutter. This manual gives instructions on the correct assembly and safe use of your hedgecutter. It is important that you read these instructions carefully.

Please record the following information. It will help your service agent if you ever need assistance or spare parts. The information is located on a label on the bottom of the machine.

The weight of the hedgecutter is 2.8 kilograms.

Model N°	
Serial N°	
Date of purchase	

## Intended Use

This product is intended for domestic use for the trimming of hedges.

## Unpacking

Carefully remove the machine from its packaging and check that you have all the following items:

1. Instruction manual
2. Blade guard

If any components are missing please call the Consumer Care Hotline on (01449) 742130 for assistance. We also have a wide network of Qualcast Approved Service Agents who you can contact for service and advice both within and outside the period of the guarantee.



### WARNING!



**THE BLADES CONTINUE TO MOVE  
FOR A FEW SECONDS AFTER THE  
HEDGE CUTTER IS SWITCHED OFF.**

## Electrical Safety

**Note:** It is recommended for increased electrical safety to use a Residual Current Device (RCD) with a tripping current of not more than 30mA. Always check your RCD every time you use it.

**Note:** Your hedgecutter is fitted with an approved 13A (BS 1363/A) electric plug and is protected by a 13A fuse (ASTA Approved to BS1362).

If the fitted plug is not suitable for your socket outlets, it should be cut off and an appropriate plug fitted in its place.

The severed plug must be disposed of to avoid a possible shock hazard and should never be inserted into a 13A socket elsewhere.

If the supply cable (fitted to the hedgecutter) is damaged contact your Qualcast Approved Service Agent.

Your hedgecutter is double insulated for safety and requires no earth connection. The operating voltage is 230V ac.50Hz.

## Extension cable

Only use an approved extension cable which is intended for outdoor use. Contact your Qualcast Approved Service Agent for details.

Fixing means for the connection leads must be used.

The connection lead must be inspected for signs of damage at regular intervals and may only be used if in perfect condition.

## Starting and Stopping

### Starting

1. Press and hold the switch Fig1A.
2. Squeeze the switch lever Fig 1B.

### Stopping

Release switch Fig 1A and/or switch lever Fig1B.

**If the blade becomes jammed during use, release the switch handles immediately.**

## Tips on Cutting a Hedge

1. Hold the hedgecutter away from you using both hands. Stand in a secure and stable position.
2. Pass the cable over your shoulder and ensure that you work in such a way that the cable is behind you at all times. **NEVER** place the cable over the hedge where it may easily be cut by the blades.
3. Cut stems upto 12mm thick. When cutting, move steadily along the line of cut so that stems are fed directly into the cutter blades. The double edge enables you to cut in either direction or with a side to side movement.
4. To keep very flat sides, it is better to cut upwards with the growth. Younger stems move outwards when the blades cut downwards and can cause shallow patches in the hedges.
5. For a very level finish, a piece of string can be stretched along the length of the hedge at the required height to act as a guide. The hedge may then be cut just above the string.
6. Take care to avoid hard objects such as wire which could cause damage to the cutting blades and the drive.
7. Optimum trimming times:-  
Hedges with green leaves, in June and October.  
Evergreen in April and August.  
Conifer and other fast growing shrubs, every six weeks from May onwards.

## After Cutting/Storage

Clean the exterior of the machine thoroughly using a soft brush and cloth. Do not use water, solvents or polishes. Remove all cutting debris, especially from the ventilation slots.

Store the hedgecutter in a dry place. Do not place other objects on top of the machine.

Ensure that the blade is covered with the blade guard supplied.

## Maintenance

### Stop, remove plug from the power supply.

**Note:** To ensure long and reliable service, carry out the following maintenance regularly.

Regularly check for obvious defects such as a loose, dislodged or damaged blade, loose fixings, and worn or damaged components. Check that covers and guards are undamaged and correctly fitted.

### Blade Maintenance

For easier operation lubricate the cutter blades before and after use, apply the oil so that it runs between the two blades.

### Rewiring the Supply Cable

We **strongly recommend** that you contact a Qualcast Approved Service Agent. The method below should only be followed by a qualified electrician.

- 1) Remove the re-wire cover Fig 2A by removing screw Fig 2B.
- 2) Loosen terminal screws Fig 2C and remove old cable Fig 2D.
- 3) Strip back supply cable as shown in Fig 3

**Note:** The copper ends of each wire should be twisted before connecting to the terminal block as shown Fig3A. **DO NOT** tin with solder.

- 4) Thread the cable Fig 2D through the cable grommet Fig 2E and connect to the terminal Fig 2F by tightening the two terminal screws Fig 2C.

Ensure the live wire is connected to the correct switch terminal Fig 2.

- 5) Route cable as shown Fig 2.
- 6) Replace cover Fig 2A by refitting screw Fig 2B.

## Declaration of Conformity

Measured values determine according to 84/538/EEC (sound pressure level at a height of 1.60 m) and EN 50144

Typically the A-weighted noise level of the product is: sound pressure level 82 dB (A) ; sound power level 93 dB (A).

The typical hand/arm vibration is below 2.5 m/s<sup>2</sup>

We declare under our sole responsibility, that this product is in conformity with the following standards or standardized documents: EN 774, EN 50 144 according to the provisions of the directives 89/336/EEC, 98/37/EC, 2000/14/EC.

2000/14/EC: The guaranteed sound power level L<sub>Wa</sub> is lower than 96 dB (A). Conformity assessment procedure according to Annex V

Notified body: .SRL Sudbury, England

Signed at Stowmarket  
Date: 2001

## Fault Finding

The following table gives checks and actions that you can perform if your machine does not operate correctly. If these do not identify/remedy the problem contact your Qualcast approved service agent.

**Warning - switch off, remove plug from mains before investigating fault.**

Symptom	Possible Cause	Remedy
Fails to operate	Is the power turned on?	Turn power on
	Is the mains socket live?	Try another socket and/or another appliance
	Has the fuse blown?	Replace fuse
	Fuse continues to blow	Contact a Qualcast Approved Service Agent
	Supply cable damaged	Contact a Qualcast Approved Service Agent
Works intermittently	Supply cable damaged	Contact a Qualcast Approved Service Agent
	Motor fault	Contact a Qualcast Approved Service Agent
Excessive vibration/ Noise	Motor fault	Contact a Qualcast Approved Service Agent

1

Step

①

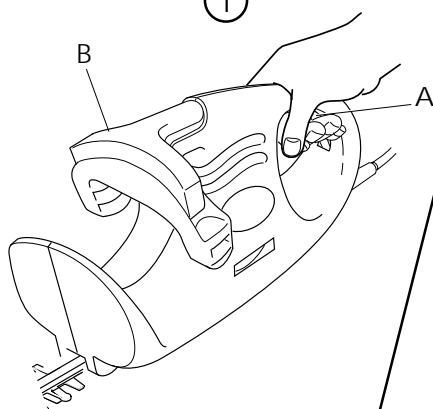

Step

②

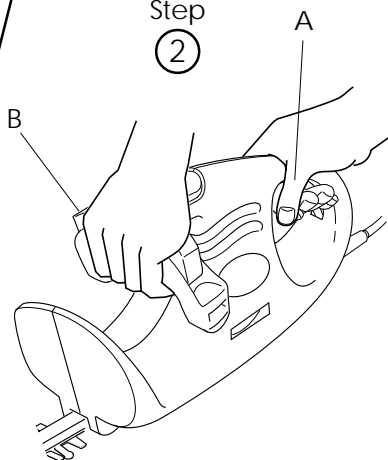

2

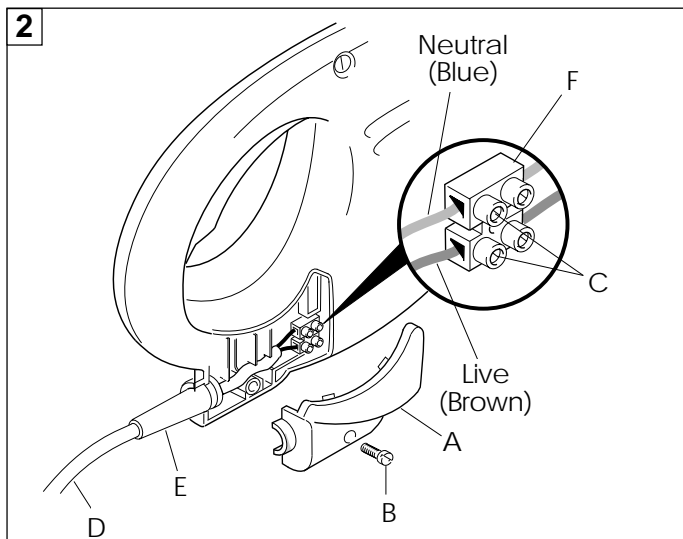

3

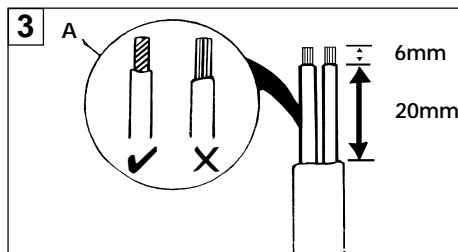

6mm

20mm

## The Guarantee

Qualcast guarantees this product against manufacturing defects. We will repair (or replace at our option) if a manufacturing defect occurs within the guarantee period as long as it has only been subjected to domestic use.

For the purpose of this guarantee, domestic use means any use of the product on the property belonging to the purchaser and forming part of the garden area of his/her dwelling.

The guarantee period is 5 years parts and 2 years labour costs from date of purchase.

***To obtain a repair under this guarantee:***

- Take the product to an approved service agent.
- Show your dated proof of purchase.
- Show this guarantee.

***The guarantee does not apply if:***

- i. You cannot provide dated proof of purchase.
- ii. The product has been resold by the original purchaser (this does not apply in the Republic of Ireland), or has been used under hire.
- iii. The product has been modified to change the manufacturers specifications, or if non genuine replacement parts have been fitted.
- iv. Any previous repair was undertaken by anyone other than an approved service agent.
- v. The fault is due to maladjustment, abuse, neglect or accidental damage.
- vi. The fault is due to lack of lubrication or maintenance.
- vii. Damage to any part, particularly the drive or cutting mechanism has been caused by allowing the product to strike solid objects.
- viii. The product develops a fault due to abnormal use.

- ix. Failure is due to normal wear. The following parts are considered as wearing parts. Their life is dependant on regular servicing and they are not therefore, normally covered by the guarantee:

Blades

Bearings

Cables

The cost of routine maintenance of the product is not covered by the guarantee.

It is in your best interest to follow the Operating Instructions for your machine, as a properly cared for product should give many years of excellent service.

Should you require replacement parts, always insist on genuine Qualcast replacement parts. Any damage caused to the product through the fitting of parts not made by Qualcast is not covered by the guarantee.

Your statutory rights are not affected by this guarantee.



### ***Environmental Information***

Your product has been manufactured under an environmental management system using, when possible, the most environmentally responsible materials and processes, and with the potential for recycling at the end of its life. The packaging is also recyclable.

When the time comes to dispose of this product please consider the environment and take it to a recognised recycling facility.

(Please contact your local authority for location information).